

old style apartment near hospital

📍 4020 Linz, Proximity: Schillerpark; Volksgarten

€ 880,-/month



Plans

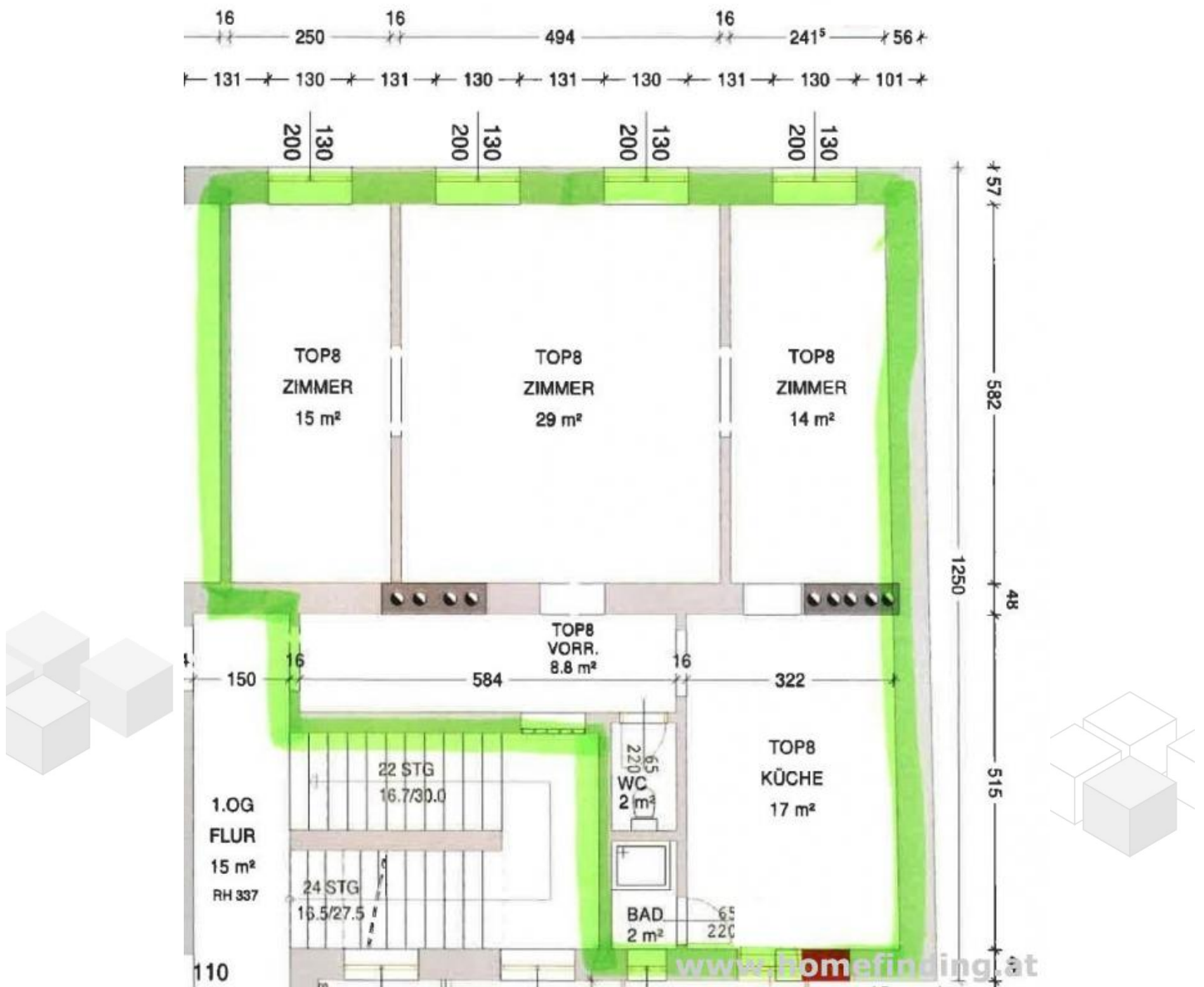

About Property

nice refurbished oldstyle apartment in a calm street near Schillerpark, easy access to international school

LOCATION

Shops, restaurants, supermarkets, pharmacies are within walking distance. The Volksgarten and Schillerpark can be reached by short walk. Public lines are nearby. Several tram- and buslines connect quickly with other parts of the city.

PUBLIC TRANSPORT

1, 2, 3, 4, 45, 46, 70, 71, 73

PROPERTY

The apartment is located on the first floor and offers following rooms:

- .entree
- .living room
- .separate kitchen
- .2 bedrooms
- .bathroom (shower, window)
- .separate toilet

EQUIPMENT

- .wooden and tiled floors
- .elevator
- .basement storage

COSTS

rent: general maintenance costs and VAT included

deposit: 3 gross rents

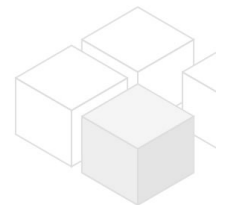

General

Property number	11664
Property type	Wohnung

Costs

total rent	€ 880,-
------------	---------

Keyfacts

living area	85.8m ²
rooms	3
bedroom	2
bath	1
WC	1

Property age	Altbau
condition	sehr gut
Available from	sofort
Contract type	befristet

Furnishing

type of heating	Etagenheizung
Flooring	Parkettboden
parking	--
kitchen	ja
elevator	ja

Energy Performance Certificate

HWB Energieklasse	D
-------------------	---

Lage

Verkehrsanbindung Nähe	1, 2, 3, 4, 45, 46, 70, 71, 73 Schillerpark; Volksgarten
---------------------------	---

